

HITACHI

Zone Controlling System

Hitachi Zone Controller

Cooling & Heating



Life

The power is in your hands.

Hitachi's innovative Zone Controller paired with Hitachi's quality Ducted system, offers you the most comfortable air conditioning solution for your home.

Up to 8 zones can be individually controlled, allowing you to condition only those rooms that need heating or cooling.

Each zone can be managed with ease, providing perfect comfort where and when you need it.



Hitachi Zone Control System



IMPROVED ENERGY EFFICIENCY & PERFORMANCE

By selectively heating or cooling parts of your home that are actively being used, you can save significantly on monthly energy consumption and expenses. In return, helping you save money.



BETTER COMFORT

With the ability to open or close dampers individually, you control the air flow into individual zones, allowing greater control over the temperature and climate throughout your home during different times of the day.

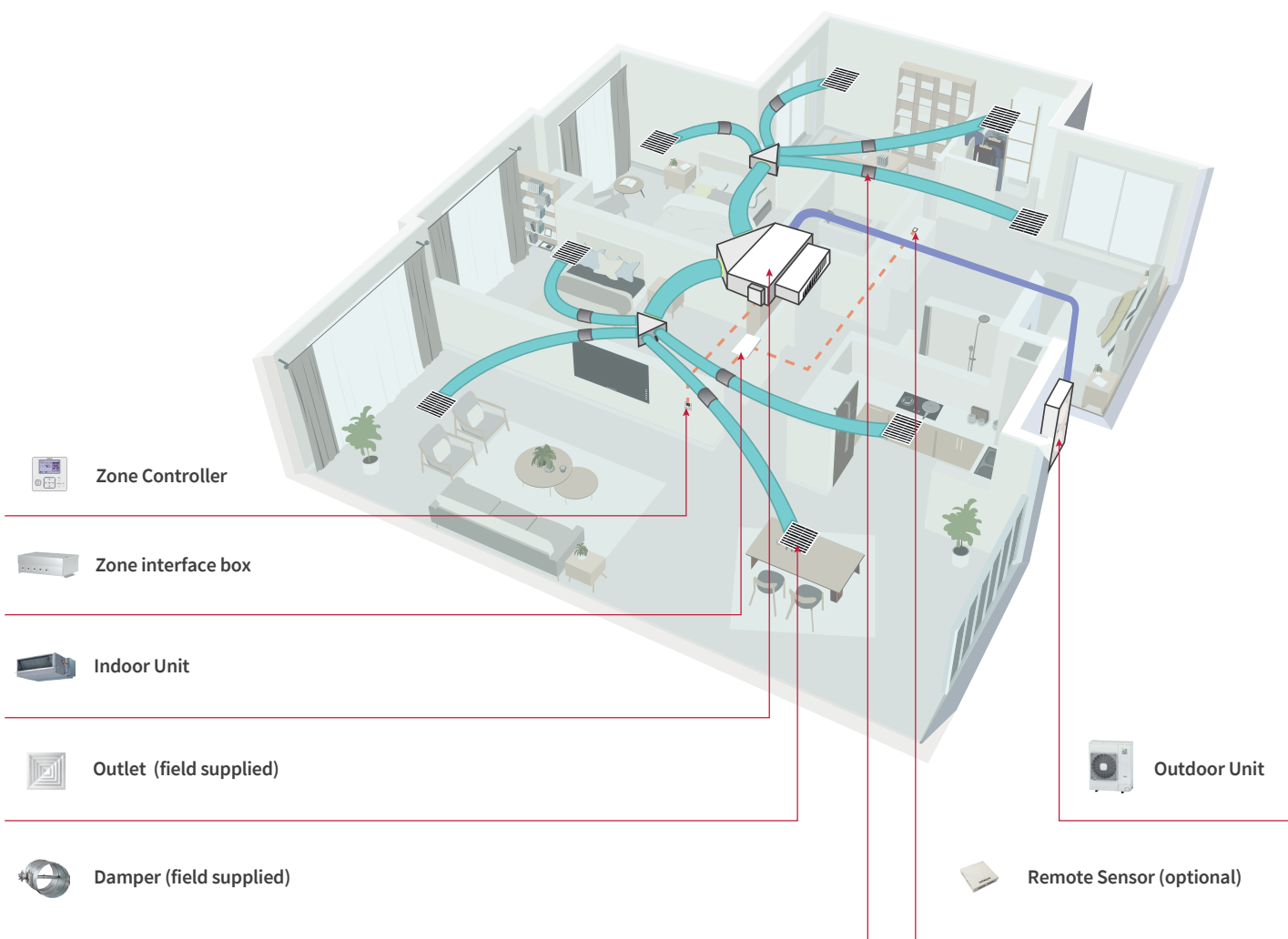

FEATURES

ZONE CONTROLLER DISPLAY



LARGE LCD SCREEN WITH BACKLIT DISPLAY

Large backlit LCD screen on the zone controller enables you to easily view individual zone status and controller functions.



ZONE NAME REGISTRATION

Each zone can be configured with a personalised name, making it easier to identify zones.



EFFORTLESS ZONE OPERATION

The zone controller has been designed with the user in mind, offering easy operation.

You can **easily switch ON or OFF** each ZONE or switch ALL zones ON or OFF simultaneously.



ON/OFF CONTROL FOR UP TO 8 ZONES

Up to 8 dampers can be connected to the zoning system. Each damper can be opened and closed freely.

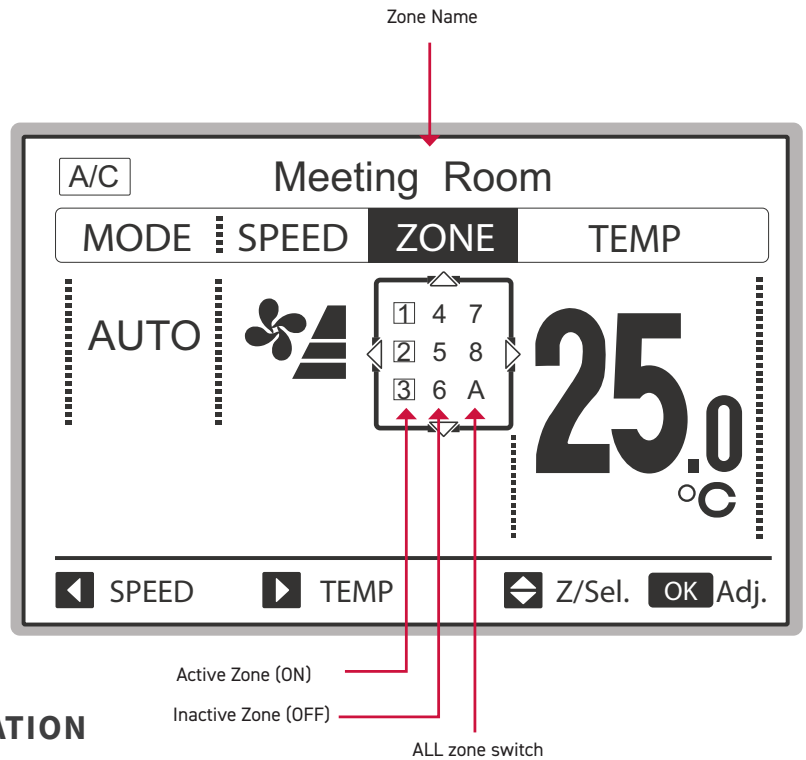

Zone On/Off		
Item	Setting	
Meeting Room	ON	▲
Master Room	ON	01
Guest Room	ON	/
Living Room	OFF	02
Kitchen Room	OFF	▼
◀ Sel. ▶ Adj. Back Rtn		

Zone On/Off		
Item	Setting	
Zone6	OFF	▲
Zone7	OFF	02
Zone8	OFF	/
		02
		▼
◀ Sel. ▶ Adj. Back Rtn		

FEATURES



POWER CONSUMPTION DISPLAY

The zone controller enables you to monitor your air conditioner's power usage for a day, week or year. Power consumption information can be displayed as a graph or table.

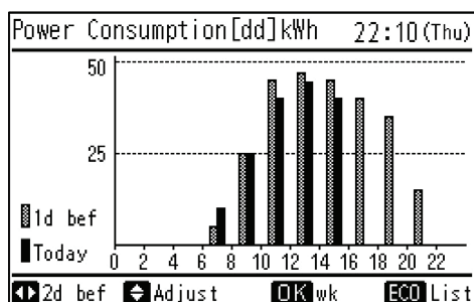

Week	2w ago	1w ago
Mon	470.0	460.0
Tue	350.0	320.0
Wed	270.0	255.0
Thu	200.0	180.0
Fri	370.0	360.0



WEEKLY TIME CLOCK

The intuitive Hitachi Zone Controller allows you to **set up to FIVE operation schedules per day** for the week, giving you control of not only when you would like your unit to operate, but select at what comfort temperature you wish the unit to operate at.

Each of these schedules can be assigned to individual zones, allowing automated operation in each zone.

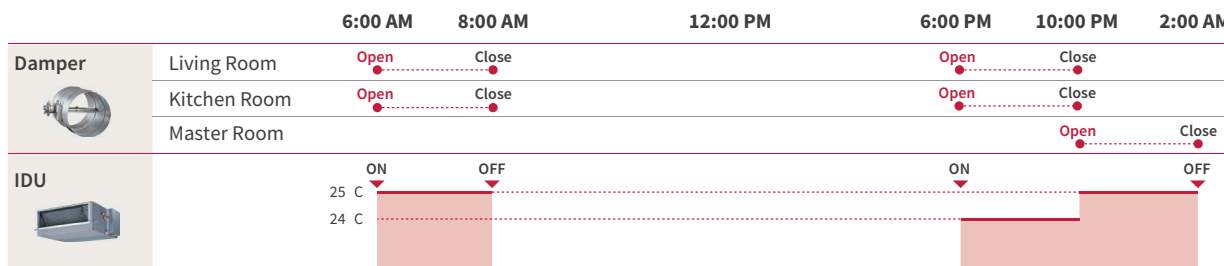

INTELLIGENT AIR-FLOW CONTROL

Selecting **Automatic fan speed** mode will allow the system to determine the optimal fan speed for the number of zones and outlets in operation, taking into account the amount of cooling or heating power needed to maintain comfort conditions.

Combining this feature along with weekly time clock schedules, not only allows set-and-forget operation, but also saves on running costs, increases comfort levels and minimises noise levels.

FEATURES

ZONE INTERFACE BOX



ZONE CONTROLLER CONFIGURATION

For added convenience, up to TWO zone controllers can be connected to an individual zoning system, making it ideal for larger or double-storey homes.



BUILT-IN 24V TRANSFORMER

The Zone Interface Box comes with a built-in 24V transformer, which not only makes for easy installation, but also reduces installation costs.



UP TO FIVE TEMPERATURE SENSORS CAN BE USED, FOR MORE PRECISE COMFORT CONTROL

Each sensor can be assigned to a zone within your home and will only activate when in operation.

When multiple sensors are active, the system will automatically average the temperature between sensors, ensuring an optimal balance in air temperature and distribution across the zones.

The available Temperature Sensors are:

- Temperature Sensor in-built to **Unit** (Standard)
- Temperature Sensor in-built to **Master** Controller (Standard)
- Temperature Sensor in-built to **Secondary** (slave) controller if used[^]
- **Remote** Temperature Sensors (up to 2 can be connected)[^]

[^] Sold Separately as an optional accessory



EASY CONNECTION FOR DAMPER

Both RJ12 plug-in connector and 3-wire connector for dampers are compatible with the Hitachi Zone Interface Box.

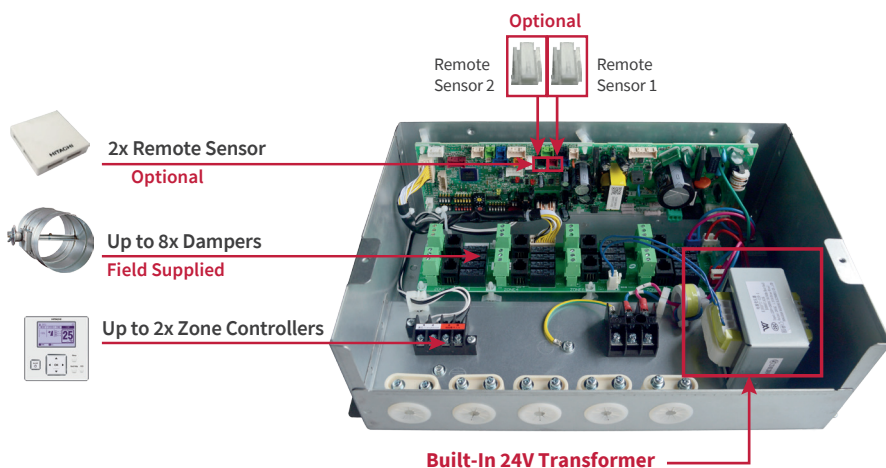

SYSTEM CONFIGURATION EXAMPLE

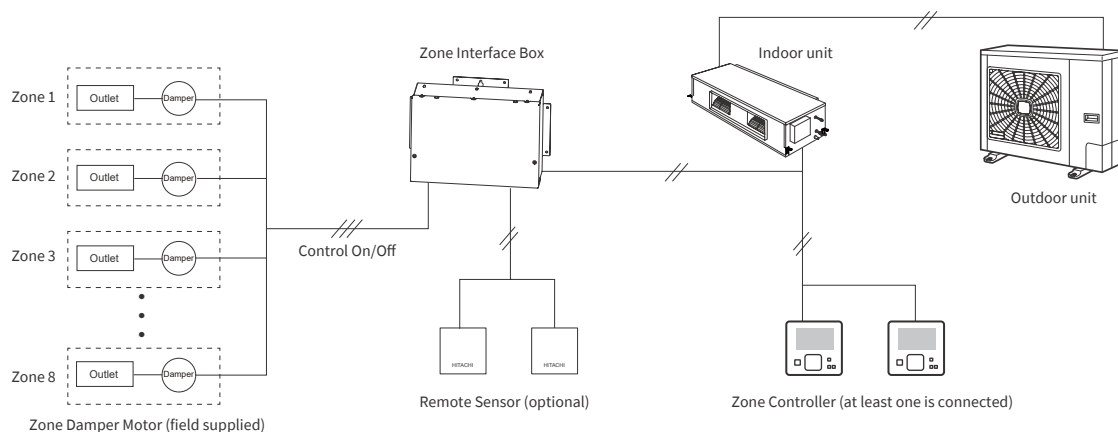

SPECIFICATIONS

PRODUCTS & DIMENSIONS

Zone Controller



Zone Interface Box



Remote Sensor



Ducted Systems

Indoor Unit

Outdoor Unit

Model Number	Indoor Unit	Outdoor Unit
	RPI-4.0FSN2SQ	RAS-4HVNC1
	RPI-5.0FSN2SQ	RAS-5HVNC1
	RPI-6.0FSN2SQ	RAS-6HVNC1
	RPI-7.0FSN2SQ	RAS-7HVRNM2

Model Name	PC-ARFZ	HZBB10NESQ	THM-R2A
Dimensions (W × D × H)	120 × 120 × 17.9 mm	324 × 226 × 110 mm	50 × 50 × 12 mm

ZONE CONTROLLER - FUNCTIONS

Screen Settings	<ul style="list-style-type: none"> • Temperature Unit • Brightness (Adjusts brightness of backlight) • Time Format 	<ul style="list-style-type: none"> • Backlight • Contrast • On/Off Lamp
Management	<ul style="list-style-type: none"> • Operation Lock/Set • Adjust Date/Time Setting • Daylight Saving Time Setting • Help Menu 	<ul style="list-style-type: none"> • Current Setting Display • Troubleshooting • Menu Operation
Schedule	<ul style="list-style-type: none"> • Weekly Schedule • Settable Timer Operation Times (5 per day) • Holiday Setting • Schedule On/Off • ODU Noise Reduction Schedule • Zone Schedule 	
Setting	<ul style="list-style-type: none"> • Run/Stop • Operation Mode • Auto Mode Setting • Temperature Setting • Master/Slave Zone Controllers Operation • Night Quiet Mode 	<ul style="list-style-type: none"> • Fan Speed • Fast Zone Control • Eco Operation • Temperature Indication • Language Settings
Service	<ul style="list-style-type: none"> • Filter Sign Reset • Test Operation • Zone Name Registration 	<ul style="list-style-type: none"> • Alarm Sign • Alarm History Display • Contact Information
Power Saving	<ul style="list-style-type: none"> • Power Saving Guidance <ul style="list-style-type: none"> • ON / OFF • LOW - MED - HIGH • ODU Capacity Control <ul style="list-style-type: none"> • Peak-Cut Control • Moderate Control 	<ul style="list-style-type: none"> • Power Consumption Display <ul style="list-style-type: none"> • 1 day / 1 week / 1 year [Graph or List] • Power Consumption Comparisons • Automatic Fan Operation • Upper Limit for Heating Operation • Lower Limit for Cooling Operation

Hitachi

temperzone Australia Pty Ltd

ENQUIRIES

sales@temperzone.com.au

AUSTRALIA

Sydney: (02) 8822 5700
Melbourne: (03) 8769 7600
Brisbane: (07) 3308 8333
Adelaide: (08) 8115 2111

DISTRIBUTORS

Newcastle: (02) 4962 1155
Perth: (08) 6399 5900
Launceston: (03) 6331 4209

NEW ZEALAND

Auckland: (09) 279 5250
Wellington: (04) 569 3262
Christchurch: (03) 379 3216



WARRANTY

Must be maintained in accordance with maintenance recommendations.

hitachiaircon.com.au

hitachiaircon.co.nz



The specifications of this catalogue may change without prior notice to allow Hitachi Cooling & Heating to incorporate the latest innovations for its customers. The information contained in this catalogue is merely informative. Hitachi Cooling & Heating declines any responsibility in the broadest sense, for damage, direct or indirect, arising from the use and / or interpretation of the recommendations in this catalogue.